

THE PIGEON HOUSE PLAN #2112-3110

Heated 2,112
Porches & Garage 998
Total Under Roof 3,110

2 Car Garage & Storage
4 Bedroom 2.5 Baths
Front Stoop & Rear Porch

61'-6" Wide
83'-6" Deep

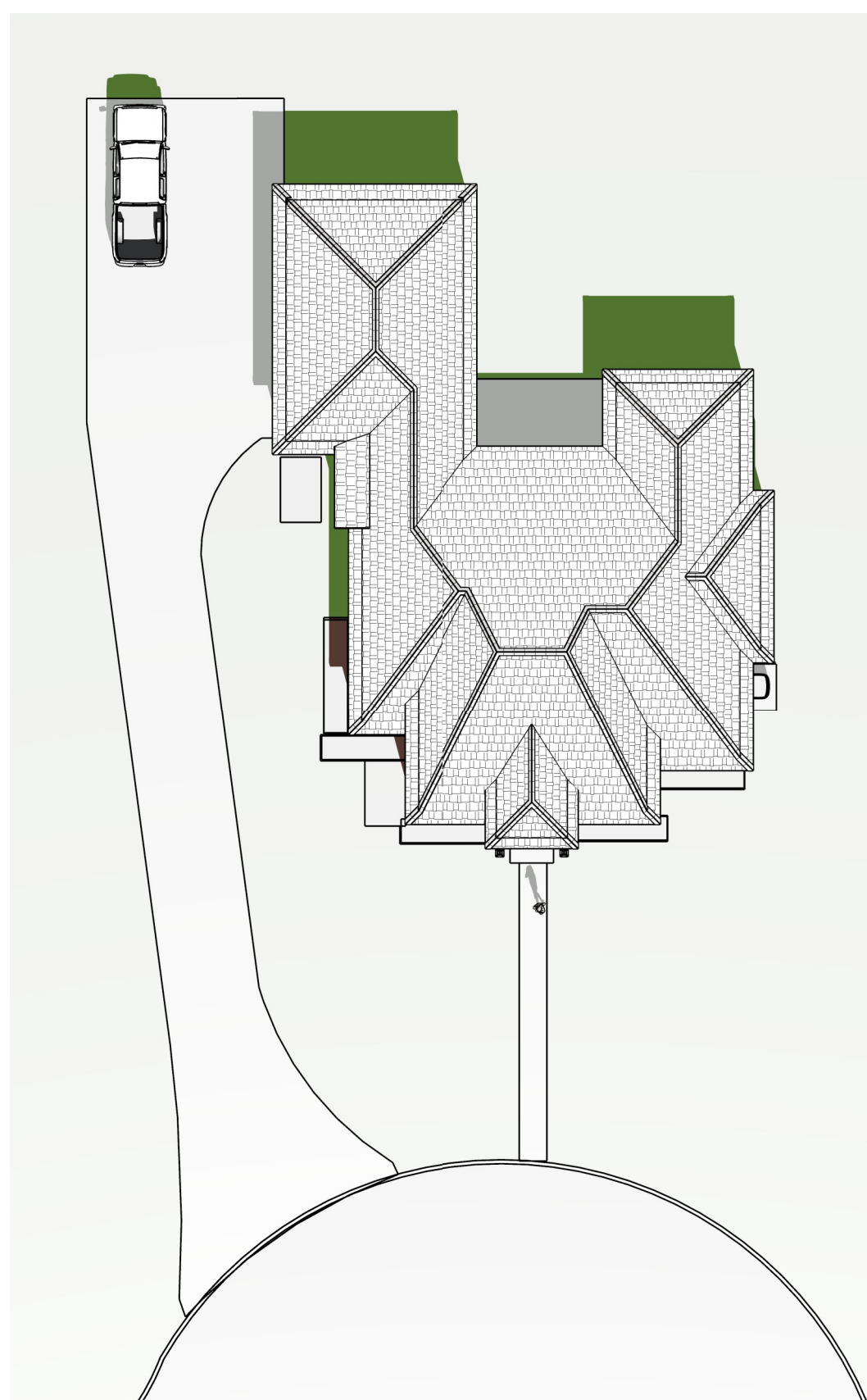

ROOF VIEW



FRONT VIEW



FRONT 3D VIEW

